

Lubricants

Centering sleeve, per sleeve approx. 6 grams

Molykote Longterm 2

Clamp connection

Tightening Torques

		Nm	(kpm)
Self-locking nuts for attachment of companion plates	M 10	45	(4.5)
	M 12	65	(6.5)
Clamping nut to universal shaft		30–40	(3–4)
Combination hex. bolt to universal shaft intermediate bearing		25	(2.5)
	M 8	25	(2.5)
Hex. bolt for attaching tunnel closing plate to frame floor	M 10	45	(4.5)
Hex. bolt for attaching engine mount to tunnel closing plate		25	(2.5)

Special Tools

Torque wrench 20–100 Nm (2–10 kpm)

001 589 35 21 00

Special open end wrench 46 mm SW

000 589 13 01 00

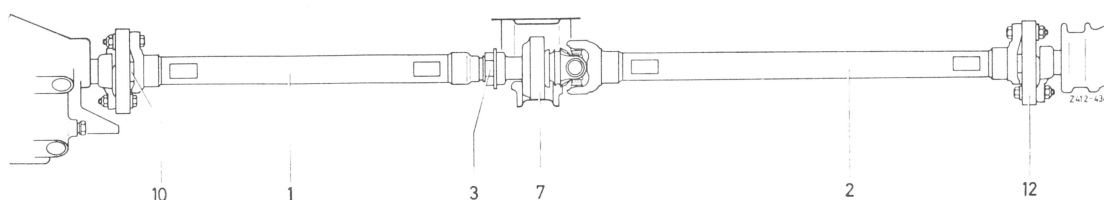

Fig. 1

- | | | |
|-------------------------|--|---------------------|
| 1 Front universal shaft | 3 Clamping nut | 10 Centering sleeve |
| 2 Rear universal shaft | 7 Universal shaft intermediate bearing | 12 Universal plate |

Removal

- 1 Remove exhaust system ("Engines" 49.1–100).
- 2 Unscrew shielding plate.
- 3 Support transmission on intermediate flange.
- 4 Loosen clamping nut of universal shaft for about 2 turns without pushing back rubber sleeve (slides along).
- 5 Unscrew hex. bolts on tunnel closing plate as well as those for rear engine mount and remove tunnel closing plate (Fig. 2 and 3).
- 6 Unflange universal shaft on transmission and on rear axle (Fig. 4).
- 7 Unscrew hex. bolts for attaching universal shaft intermediate bearing on frame floor.

41.1 Removal and Installation of Universal Shaft

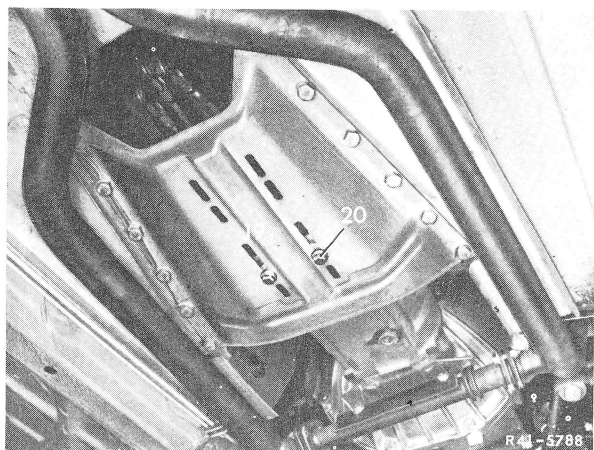

Fig. 2

- 19 Tunnel closing plate
- 20 Hex. bolt for attaching engine mount

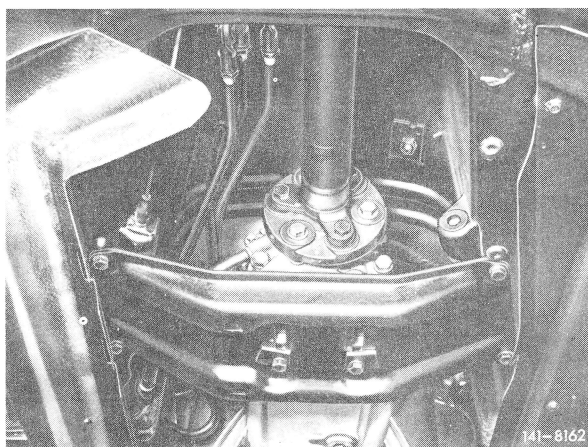

Fig. 3

8 Remove universal shaft from centering pin of rear axle and pull out in rearward direction (Fig. 5), making sure that the universal shaft is not separated.

Important Note! If the universal shaft must be separated, mark components in relation to each other for subsequent reassembly, so that the completely balanced shaft will not become unbalanced.

9 Check universal plates, centering sleeves and universal shaft intermediate bearing for damage. Replace damaged parts.

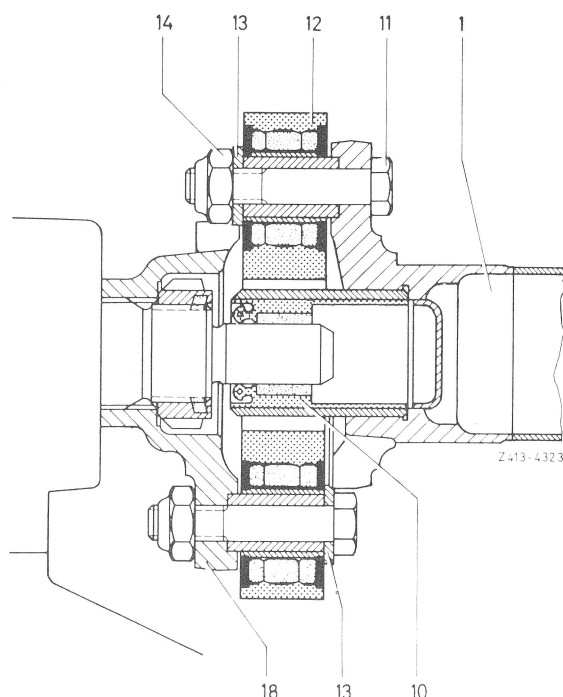

Fig. 4

- 1 Front universal shaft
- 10 Centering sleeve
- 11 Hex. bolt
- 12 Companion plate
- 13 Washer
- 14 Self-locking nut
- 18 Three-legged transmission flange



Fig. 5

Installation

10 Fill cavities of two centering sleeves with Molykote longterm 2.

11 Slide universal shaft complete with companion plates on centering pins on transmission and on rear axle.

12 Lightly attach universal shaft intermediate bearing.

13 Flange universal shaft to transmission and to rear axle (Fig. 6). Tightening torques refer to page 1.

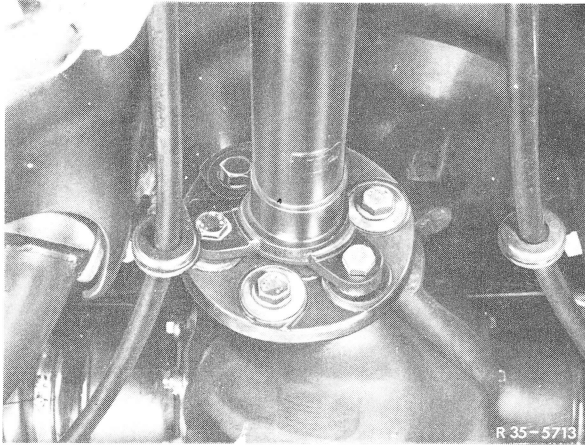

Fig. 6

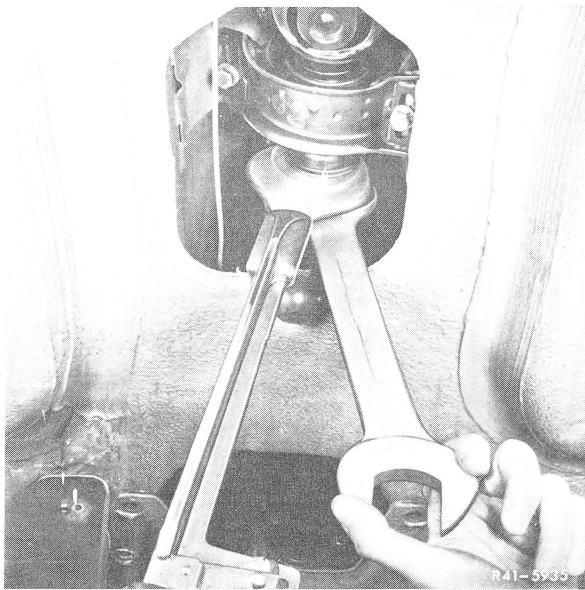

Fig. 7

14 Attach tunnel closing plate to frame floor (Fig. 2 and 3). Tightening torques refer to page 1.

15 Remove transmission from support, position hex. bolts for rear engine mount and tighten to 25 Nm (2.5 kpm).

16 Move vehicle ready for driving back and forth several times. Only this will adjust the universal shaft for correct length and installation free of tensions is assured.

17 Tighten clamping nut on universal shaft, watching out for good seat of sleeve (Fig. 7). Tightening torque 30–40 Nm (3–4 kpm).



Fig. 8

14 Combination hex. bolt 15 Clamping nut

18 Tighten hex. bolts for attaching universal shaft intermediate bearing to frame floor to 25 Nm (2.5 kpm) (Fig. 8).

19 Mount shielding plate (Fig. 9).

20 Install exhaust system ("Engines" 49.1–100).

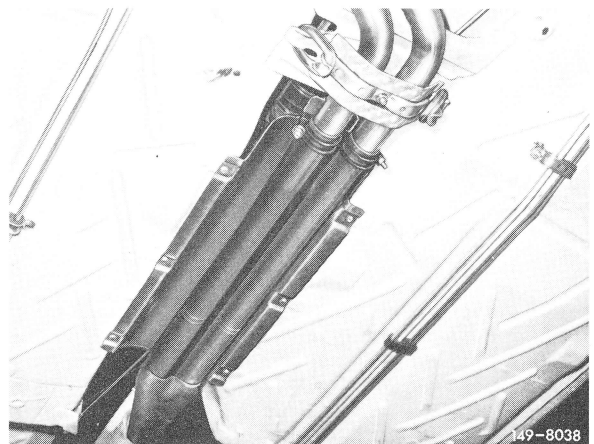

Fig. 9